



National Association
for Music Education



2024 Biennial NAfME Music Research and Teacher Education Conference

**The Westin Peachtree Plaza, Atlanta, Georgia
September 25–28, 2024**

PROGRAM GUIDE



AT WILLIAM CAREY UNIVERSITY



WILLIAM CAREY
UNIVERSITY

WINTERS SCHOOL of MUSIC

One Goal, One Passion



FOLLOW US ON SOCIAL MEDIA
@wmcareymusic



For More Information
Scan this QR Code

*The Winters School of Music
invites you to be a part of
the William Carey family!*

- Incredible Scholarships
- Mississippi's FIRST All-Steinway School
- Bachelor degrees in Music Education, Worship Leadership, Worship Technology, Music Therapy, Performance and more!
- FULLY ONLINE Doctor of Arts in Music, Master of Music Education, and Master of Music in Worship Studies
- Top 10 Most Affordable Online Music Degrees according to Online U!

2024/2025 Scholarship
AUDITION DAYS

Friday, November 15 | Friday, January 17 | Friday, March 7

To reserve an audition day or request a time that works better for you, please email music@wmcarey.edu or call 601-318-6175.

Save the Dates

Carey Honor Band
January 30 – February 1

Carey Jazz Festival
March 21

Carey Honor Choir
April 10-12

Program Guide Contents

Welcome Messages | 4-6

- Deb Confredo, NAFME President and Conference Chair
- Wendy Sims, Chair, Society for Research in Music Education (SRME)
- Ann Marie Stanley, Chair, Society for Music Teacher Education (SMTE)

Thank You to Leaders and Contributors | 7-9

- The Biennial Conference Planning Committee
- SRME and SMTE Reviewers
- SRME and SMTE Presiders

Important Conference Information | 9

- Detailed Conference Session Program and Conference app
- Hotel Address, Airport, Local Transportation, Parking
- Local Restaurants, Activities, and Amenities
- Registration Area

Preconference Forum – Transforming Music Teaching and Learning Together | 11

Plenary Sessions | 12-14

- Keynote - Omar Thomas
- Senior Researcher Address

NAfME Invited Sessions | 15

Conference Overview Schedule | 16

Hotel Floorplan Maps | 17-20

Conference program as of August 30, 2024.

A note for advertisers:

There's still time to purchase ad space in this digital program before the conference. The deadline to reserve your space and supply artwork is September 15. Program advertisers will also be highlighted in the conference app and thanked publicly onsite. Contact Ellie Dunn at ellie@carldunn.com for details.

Welcome Messages



Deb Confredo
President (2024-2026),
National Association for Music Education

Hello Friends.

On behalf of the National Association for Music Education, I want to welcome you to Atlanta and the 2024 Biennial NAFME Music Research and Teacher Education Conference! These are going to be exciting and very full days. With a packed slate of presentations, panel discussions, round tables, and poster sessions, there is something for everyone. I suspect that it will be difficult to pick and choose which sessions to attend; this is a good dilemma! Colleagues from around the country are set to share with you a rich kaleidoscope of offerings that are focused on growing our understanding of and support for music teaching and learning.

NAfME is committed to providing time and space for dissemination of data, meaningful conversation, and healthy debate in our pursuit of cultivating a flourishing profession for the good of all who experience music. To this end, we are reminded of our statement of beliefs:

- Music is unique to the human experience and is essential to our humanity.
- Music communicates and connects people across all time and cultures.
- Music unlocks human creative expression and is a lens to the experiences and interpretations of the world.
- Music is basic to human wholeness through our emotions, intellect, and physical and spiritual well-being.

Remember to take notes, ask good questions, think and question, listen and learn. Connect with old friends and make a bucketful of new ones. Seasoned members, reach out and interact with those who are newer to the profession—share your wisdom and learn the latest from them. Younger folks and those who are newer to the profession, reach out and interact with your seasoned colleagues—share thoughts about music teaching and learning from your perspective and absorb the wisdom of their experiences. Stop me as we pass each other to say hello. Let me know your ideas and share your good news.

Get inspired and be an inspiration! We are so much better for all of your efforts. We celebrate your work, and we celebrate you! Welcome to Atlanta!

Welcome Messages



Wendy Sims
Chair, Society for Research in Music
Education (SRME)

Welcome to the 2024 NAFME National Conference, on behalf of the Executive Committee of the Society for Research in Music Education (SRME). We are excited to be able to provide so many high-quality research and special session presentations, poster sessions, and sessions organized by our 15 Special Research Interest Groups (SRIGs). This conference provides one of our profession's best opportunities for professional development. We hope you will take full advantage of the opportunity to learn about cutting-edge original research and research-related topics, engage in thought-provoking discussions, interact with presenters—especially those whom you may only have “met” through reading their articles—and enjoy

establishing or renewing connections with music educator friends and colleagues.

An undertaking such as this is only possible with the hard work of many individuals, and so there are many people to thank. The leadership of NAFME past president Scott Sheehan, NAFME president Deborah Confredo, and the SRME Executive Committee members serving as conference program co-chairs, Phillip Hash and Beatriz Ilari, has been invaluable.

We are grateful to the NAFME staff team for the countless hours they have spent working on conference organization, arrangements, correspondence, schedules, and documents. Thanks to the SRME Executive Committee members, SRIG chairs, and editorial committee members of the *Journal of Research in Music Education* and *Update* who reviewed the many submissions and are serving as session presiders with the assistance of State Research Chairs. We appreciate the collaboration of the leaders of the Society for Music Teacher Education, Sean Powell, Jay Dorfman, and Ann Marie Stanley, for their many efforts on behalf of this event.

Thank you, as well, to all the conference presenters for your contributions to our NAFME research community. We hope that all of you who present and attend will be inspired and motivated to continue your research activities and submit your work for the 2026 conference.

Best wishes for an exciting and stimulating conference experience!

Welcome Messages



Ann Marie Stanley
Chair, Society for Music Teacher
Education (SMTE)

Welcome to Atlanta and the 2024 Biennial NAFME Music Research and Teacher Education Conference. It has been terrific to see the dream team of the SMTE Executive Committee, the SRME Executive Committee, and the NAFME National Executive Board partner with the capable NAFME staff to bring this conference to life. I offer special kudos to SMTE Past Chair Sean Robert Powell and SMTE Past Communications Chair Jay Dorfman, as they did so much of the work in preparation for this event. I know you will note all these folks' thoughtfulness and gracious attention to detail as you move through the conference events.

I hope this conference is a place where we can renew friendships *and* find new collaborators. Like many of you, I anticipate this conference as a time to reunite with former

colleagues and grad school friends. I look forward to seeing cutting-edge research posters and hearing new research findings. At this gathering, we traditionally give especially warm welcomes to those new to our profession, while simultaneously honoring our most esteemed, established researchers. Right now—while both Societies and NAFME at large converge in Atlanta—is a great time to connect intellectually and emotionally back to those leaders and thinkers who have influenced our practice for decades. It's also an opportunity to open our minds to new and challenging ideas. Why not use the time away from our comfortable home routines to shake things up?

I sense a real enthusiasm for making tangible progress toward our shared professional goals, through making big, innovative changes; let's do that by questioning our assumptions and asking others to question theirs. The best thing about the NAFME Biennial has always been that storied tradition and breakthrough ideas exist side by side and influence each other for the better.

Please let me know your thoughts, questions, and wonderments when I see you during the conference. I truly look forward to hearing your stories about how you experienced the richness of this Biennial. Enjoy the conference!

Thank You to Leaders and Contributors

Thank you to the 2024 organizing committee and other contributors!

2024 NAFME Biennial Music Research and Teacher Education Conference Planning Committee Members:

- Deb Confredo, NAFME President and Conference Chair
- Scott Sheehan, NAFME Immediate Past President
- James Daugherty, Immediate Past President, Southern Division; NAFME National Executive Board Executive Committee Member
- NAFME Music Teacher Profession Advisory Committee Co-Chairs
 - Cecil Adderley, NAFME President-Elect
 - Carlos Abril
- Society for Research in Music Education (SRME) Conference Co-Chairs
 - Wendy Sims, SRME Chair
 - Phillip Hash, SRME Chair-Elect
 - Beatriz Ilari, SRME Executive Committee member
- Society for Music Teacher Education (SMTE) Conference Co-Chairs
 - Ann Marie Stanley, SMTE Chair
 - Jay Dorfman, Immediate Past Chair, SMTE Communications

Thank You to Leaders and Contributors

SRME Reviewers:

Johanna Abril

Sarah Bartolome

Melissa Baughman

Ruth Brittin

Nathan Buonviri

Casey Clementson

Jason Cumberledge

Amanda Draper

William Fredrickson

Andrew Goodrich

Carl Hancock

Josef Hanson

Phillip Hash

Karin Hendricks

Jay Juchniewicz

Sangmi Kang

Steve Kelly

Martin Norgaard

Jessica Naples

Evelyn Orman

Elizabeth Parker

Kelly Parkes

Sean Powell

Jared Rawlings

Brad Regier

Lauren Kapalka Richerme

Charlene Ryan

Julia Shaw

Ryan Shaw

Jason Silveira

D. Gregory Springer

Laura Stambaugh

Bridget Sweet

Leonard Tan

Don Taylor

Matthew Thibeault

Victoria Warnet

Matthew Williams

Hyesoo Yoo

John Rine Zabanal

SMTE Reviewers:

Chris Baumgartner

Jacob Berglin

Jason Bowers

Kelly Bylica

Colleen Conway

Sommer Forrester

Benjamin Guerrero

Peter Hamlin

Daniel Hellman

Jacqueline Henninger

Nate Kruse

Whitney Mayo

Colleen McNickle

Emily Mercado

Angela Munroe

Nicole Ramsey

Allyson Rottman

Karen Salvador

Lorenzo Sanchez-Gatt

David Sanderson

Alec Scherer

Elizabeth Schulz

Ryan Shaw

Rachel Sorenson

Don Taylor

Olivia Tucker

Aaron Wacker

Brian Weidner

Krissie Weimer

Jill Wilson

Erin Zaffini

Thank You to Leaders and Contributors

SMTE Session Presiders

Jennifer Aikey
Chris Baumgartner
Jacob Berglin
Jason Bowers
Colleen Conway
Tami Draves
Benjamin Guerrero
Peter Hamlin
Daniel Hellman
Shannan Hibbard
Steve Kelly
Emily Mercado
Angela Munroe
Austin Norrid
Sean Powell
Nicole Ramsey
Karen Salvador
Lorenzo Sánchez-Gatt
Dave Sanderson
Alec Scherer
Ryan Shaw
Rachel Sorenson
Ann Marie Stanley
Don Taylor
Olivia Tucker
Brian Weidner

Krissie Weimer
Leon Williams
Matthew Williams
Jill Wilson
Erin Zaffini

SRME Session Presiders

Melissa Baughman
Jacob Berglin
Melissa Brunkan
Annalisa Chang
Jason Cumberledge
Amanda Draper
Victor Fung
Casey Gerber
Melissa Grady
Russell Greene
Carl Hancock
Josef Hanson
Dan Healy
Libby Hearn
Ted Hoffman
Beatriz Ilari
Jay Juchniewicz
Sangmi Kang
Roy Legette
Nicholas McBride

Edward McClellan
Jessica Nápoles
Evelyn Orman
Elizabeth Parker
Kelly Parkes
Sean Powell
Jesse Rathgeber
Brad Regier
Lauren Kapalka Richerme
Charlene Ryan
Mandi Schlegel
Julia Shaw
Jason Silveira
Wendy Sims
Greg Springer
Alden Snell
Laura Stambaugh
Christina Svec
Don Taylor
Victoria Warnet
Scott Whitman
Matthew Williams
Hyesoo Yoo

Important Conference Information

Detailed Conference Program and Session Information and the Conference App

Please note that there will not be a printed conference program for this conference. Attendees will be able to access a complete schedule with session details in the following ways:

- Access the complete conference program (PDF) on [NAfME's conference website](#). This program will be regularly updated. It will have complete information on all sessions, including title, session description, speakers, date, time, and room location.
- The conference app. Prior to the conference, speakers and attendees will be provided with access to the conference app (Whova is the name of the app that will be used). Make sure to download and use the app to find sessions and network with your colleagues! Updates to the program will be announced through the app.
- A couple of copies of the program for reference if needed will be available at the NAfME registration desk during the conference.

Hotel Address, Airport, Local Transportation, Parking

- The [Westin Peachtree Plaza](#) is located at 210 Peachtree St. NW, in downtown Atlanta, Georgia. Hotel phone number: +1-404-659-1400.
- It is about 10 miles from Hartsfield-Jackson Atlanta International Airport.
- The closest subway station is MARTA-Peachtree station, which is about a 2-minute walk from the hotel. Rideshare services and taxis are also available from the airport.
- Parking at the hotel is valet only, at a daily rate of \$55.00.

Local Restaurants, Activities, and Amenities

- [Learn about restaurants](#) at The Westin Peachtree Plaza and near the hotel.
- Visit [Discover Atlanta](#) to learn more about Atlanta, including things to do and places to eat.

Registration

Conference registration will be located on the 6th floor, The Overlook.

Preconference Forum

Preconference Forum – Transforming Music Teaching and Learning Together

September 25, 1:00 – 5:00 PM, Chastain 1

This forum offers four sessions across two strands which are designed to engage attendees in meaningful discussions and group tasks toward transforming and strengthening the profession.

Cultivating Leadership from the Beginning

- 1:00 – 1:50 PM **Tapping the Potential of Pre-Service Music Teachers** (Steven Kelly, Nicholas Matherne, Majoris Regus, Robert Bryant)

This session will be an interactive conversation with attendees, discussing how the profession can and should draw on the energy, enthusiasm, brightness, and imagination of undergraduates as they pursue a career in music education. Attracting, educating, and retaining more potential undergraduates from a variety of backgrounds and experiences with an eye toward remodeling music education curricula will be addressed.

- 2:00 – 2:50 PM **Championing Early Career Music Teacher Educators** (Linda Thornton, Krissie Weimer, Greg Springer, Roy Legette)

This session will be an interactive conversation with attendees, discussing implementable ways to approach improving the experience of all early career music teachers, particularly those in years 1-5. Special attention will be paid to identifying the advantages of teaching students in underserved communities as well as in rural and geographically distanced schools. Ways to connect veteran and novice music educators in meaningful ways will be discussed.

Unity, Strength, and Community in Music Education

- 3:00 – 3:50 PM **Succeeding Together Through Mentorship and Affinity Groups** (Matthew Koperniak, Shane Colquhoun, Johnathan Hamiel)

This session will be an interactive conversation with attendees, discussing the benefits of mentorship for all—mentors and mentees. Models of mentoring processes will be shared and suggestions for implementing helpful mentoring programs will be solicited. The value of affinity groups will have a strong focus in this session, especially as it relates to belonging, shared life and work experiences, and strength through professional camaraderie.

- 4:00 – 4:50 PM **Drawing on the Power of Partnerships** (Cecil Adderley, Scott Sheehan, Emily Mercado, Kelly Parkes, Amanda Karhuse)

This session will be an interactive conversation with attendees, discussing the wellspring of resources and support that can come from developing strong relationships between educators and partners who share similar vision and goals. Working effectively together will be a primary focus, along with productive means for starting and nurturing robust alliances with music teaching and learning as the centerpiece.

Note: this preconference forum has a separate registration fee. See the conference registration page on NAFME's website for details.

Plenary Sessions

Keynote Session – September 26, 3:15 – 4:30 PM, Peachtree Ballroom



**Conference Keynote
Speaker: Omar Thomas**

Closing the Gap: Catching Up to the Reality of a Musical World

The field of music education is attempting to close a gap of our own making between ourselves and the ways music exists (and in many ways has been existing) for decades and more. Those of us who operate within formal music educational institutions must call upon ourselves to shift from a reactionary model of curriculum building and music making to a proactive model, where we empower and prepare our students to not only take part in, but to also lead the conversations that shape the reciprocal connection between the greater musical landscape and culture.

Omar Thomas is an acclaimed jazz musician, educator, arranger, and award-winning composer. Described as “elegant, beautiful, sophisticated, intense, and crystal clear in emotional intent,” the music of Omar Thomas (b. 1984) continues to move listeners everywhere it is performed. Born in Brooklyn, New York, to Guyanese parents, Omar received his Bachelor of Music in Music Education from James Madison University and his Master of Music in Jazz Composition at the New England Conservatory of Music in 2008. He is the protégé of lauded composers and educators Ken Schaphorst and Frank Carlberg and has studied under multiple Grammy-winning composer and bandleader Maria Schneider.

Hailed by Herbie Hancock as showing “great promise as a new voice in the further development of jazz in the future,” Omar Thomas has created music extensively in the contemporary jazz and symphonic idiom. Omar has previously served as an Associate Professor of Harmony at Berklee College of Music and on faculty in the Music Theory department of The Peabody Institute of The Johns Hopkins University. He currently serves as Assistant Professor of Composition and Jazz Studies at The University of Texas at Austin. He has thrice been awarded the Certificate of Distinction in Teaching from Harvard University, where he served as a Teaching Fellow for four years. Omar was awarded the Boston Music Award’s “Jazz Artist of the Year” in 2012, and in 2017, Omar was selected from an international pool of applicants to be an artist-in-residence at the Cité Internationale des Arts in Paris. In 2019, he was awarded the National Bandmasters Association/Revelli Award for his wind composition “Come Sunday,” becoming the first Black composer awarded the honor in the contest’s 42-year history.

Now a Yamaha Master Educator, Omar has become a highly sought-after speaker and thought leader on issues of diversity and equity in music education. Most recently he served as the 2023 College Music Society National Conference Trotter Lecturer and gave the keynote speech at the National Association of Schools of Music (NASM) 2023 Annual Meeting. His music has been performed in concert halls and on stages across the country and internationally by such renowned groups as The United States Marine Band, The Houston Symphony, The Colorado Symphony, and the Showa Wind Symphony, to name a few. He has had a number of celebrated singers perform over his arrangements, including Stephanie Mills, Yolanda Adams, Nona Hendryx, BeBe Winans, Kenny Lattimore, Marsha Ambrosius, Sheila E., Leela James, Dionne Warwick, and Chaka Khan. His work is featured on

Plenary Sessions

Keynote Session – September 26, 3:15 – 4:30 PM, Peachtree Ballroom



Omar Thomas conducting at the 2023 Reno Jazz Festival

Dianne Reeves's Grammy Award-winning album *Beautiful Life*. His big band, the 18-piece Omar Thomas Large Ensemble, was formed in 2008. The group's first album, *I Am*, debuted at #1 on the iTunes Jazz Charts and peaked at #13 on the Billboard Traditional Jazz Albums Chart. Their second release, *We Will Know: An LGBT Civil Rights Piece In Four Movements*, has been hailed by Grammy Award-winning drummer, composer, and producer Terri Lyne Carrington as being a "thought provoking, multi-layered masterpiece" which has "put him in the esteemed category of great artists." Says Terri Lyne: "Omar Thomas will prove to be one of the more important composer/arrangers of his time."

Photo credits: Izzy Berdan (top); Rob Retting Photography (lower)

Musical Performance - Pace Performers, September 26, 3:05 – 3:20 PM

CANCELED: Due to the impact of Hurricane Helene in the Southeastern U.S., school was closed for this performing group and they were not able to perform as scheduled.



Under the direction of NAfME member Erin Oxford, Pace Performers is the premier performance choir from Kay Pace Elementary School of the Arts, in Clayton County, Georgia, consisting of students in 3rd, 4th, and 5th grades. Officially beginning in 2018, Kay Pace was founded in Jonesboro, Georgia. The choir performed at the 2024 GMEA annual conference and regularly performs throughout the community.

Plenary Sessions



**Senior Researcher
Address: Chris Johnson**

SRME Business Meeting and NAFME 2024 Senior Researcher Address Plenary, September 27, 5:10 – 6:10 PM

Chris Johnson, 2024 Senior Researcher Award Acceptance
Address: Gaining Perspective from the Passage of Time

This session will explore the evolving research community over time. The often overlooked yet profound impact that published research can have on practitioners and, ultimately, on students' lives will be explored. The session will also examine how the research activity has changed and advanced over the years. Lastly, the accelerating pace of change in our world will be addressed, along with how these opportunities to innovate and make a difference can be approached.

Chris Johnson is Professor and Chair of Music Education and Music Therapy and Director of the Music Research Institute at the University of Kansas. Chris is a distinguished researcher, publishing frequently in the Journal of Research in Music Education (JRME) and other important journals, and presenting at every national NAFME biennial conference for the past 30+ years, among other conferences. He has represented the U.S. research community through active participation in the International Society for Music Education. Chris has mentored many doctoral students who have gone on to make their own contributions to the field. He has been a recognized leader in the research community, having served on the JRME Editorial committee, as a SRIG chair, and on the SRME executive committee, including as chair.



**National Association
for Music Education**

NAfME Thanks the Georgia Music Educators Association for Their Support of the 2024 Biennial NAFME Music Research and Teacher Education Conference

The annual GMEA In-Service Conference (ISC), "**Committed to Positively Changing Lives,**" is coming up January 30-February 1, 2025 in Athens, Georgia! It will feature 130+ clinic sessions with some of the nation's greatest clinicians and teachers along with 40+ performances from groups located all around the state of Georgia. The ISC is attended by more than 4,000 people, including music directors from elementary to college levels, fine arts supervisors, college students, school administrators, students and professional musicians performing with selected performing groups, exhibitors, and family members of performing students.

Visit gmea.org for more information about all GMEA's programs and services.



NAfME Invited Sessions

Special Topic NAfME Sessions

Please note the following special topic NAfME invited sessions that will be taking place during the conference.

Sessions focus on various aspects of NAfME's [*A Blueprint for Strengthening the Music Teacher Profession*](#) (released in June 2023):

- **Defining What It Means to be a Music Educator Today**

September 26, 9:40 – 10:40 AM, Augusta E-F

This interactive discussion focuses on current perceptions of the profession, recruitment approaches that stretch the boundaries of past practices to reach prospective undergraduates who may not have previously seen themselves in the profession, identifying and searching for potential, and knowledge of the profession to shape next generations of music teachers. Deb Confredo, Jacqueline Henninger, Amanda Schlegel, Loneka Wilkinson Battiste, Adrian Davis

- **Planning and Realizing Research Toward Blueprint Goals**

September 26, 1:30 – 2:30 PM, August C-D

Panelists will discuss the development and implementation of a research agenda that engages a network of music teacher educators, music teachers, and music education partners. Topics derived from *A Blueprint for Strengthening the Music Teacher Profession*, as well as research strategies and outcomes, will be proposed. Deb Confredo, Wendy Sims, Phillip Hash, Ann Marie Stanley, Jared Rawlings

- **Working with Faculty to Effect Curricular Change**

September 27, 11:05 AM – 12:05 PM, Chastain G-H

Panelists will share perspectives on working with faculty to create impactful changes in the music education curriculum. Emphasizing effective communication and shared goals, the discussion aims to ensure the curriculum evolves to best serve the needs of future music educators and their students.

Carlos Abril, Ann Marie Stanley, Shane Colquhoun, Kelly Parkes, Karen Salvador

- **Growing and Sustaining Relationships Between PreK-12 Schools and Universities**

September 27, 1:20 – 2:20 PM, Chastain G-H

Participants will share how their contributions in maintaining open communication between PreK-12 schools and universities helps to better understand the needs of the local communities.

Panelists will share their input on encouraging curricular change and provide a deeper understanding of how candidates are prepared and how graduates are supported as they are placed locally.

Cecil Adderley, Lisa Leach, Scott Burgener, Sonya White-Hope, Patrick Freer, Bryan Powell

NAfME Connected Arts Networks (CAN) grant session:

- **Transforming Music Teaching and Learning through the Connected Arts Networks' Virtual Professional Learning Communities**

September 27, 9:05 – 10:05 AM, August E-F Discover how NAfME's Connected Arts Networks virtual PLCs transform music teaching and learning across diverse settings throughout the United States. Together, we will explore evidence-based strategies integrating EDI and SEL, fostering teacher leadership, and enhancing student outcomes. Join us as we provide innovative and practical approaches that are supporting and empowering and building community for hundreds of music and arts educators nationwide.

LaSaundra Booth, Angela Keedy, Krissi Davis, Ashleigh Spatz, Troy Williams, Michael Gordon

Conference Overview Schedule

Conference Overview Schedule

Note: for a complete listing of all meetings and presentation and poster sessions, including session titles, abstracts, speakers, dates, times, and rooms, see the separate detailed program schedule (PDF) on NAFME's website and the conference app (available from September 9).

September 25	8:00 AM	6:00 PM	The Overlook	Registration Open
	9:00 AM	6:00 PM		Society and Editorial Committee Meetings, Piedmont Level
	1:00 PM	5:00 PM	Chastain 1	Preconference Forum: Transforming Music Teaching and Learning Together
September 26	7:00 AM	5:00 PM	The Overlook	Registration Open
	8:00 AM	3:05 PM	Peachtree A	Wellness Room open space sponsored by SMTE Wellness ASPA
	8:30 AM	10:40 AM		Presentation Sessions
	10:55 AM	12:10 PM	Peachtree B - Foyer	Poster Session 1
	1:30 PM	3:05 PM		Presentation Sessions
	3:05 PM	3:20 PM	Peachtree Ballroom	Musical Performance: Pace Performers
	3:15 PM	4:30 PM	Peachtree Ballroom	Plenary Session: Keynote Speaker - Omar Thomas
	4:45 PM	6:00 PM	Peachtree B - Foyer	Poster Session 2 and Welcome Reception
September 27	7:30 AM	5:00 PM	The Overlook	Registration Open
	8:00 AM	3:30 PM	Peachtree A	Wellness Room open
	8:30 AM	12:05 PM		Presentation Sessions
	1:20 PM	3:30 PM		Presentation Sessions
	3:45 PM	5:00 PM	Peachtree B – Foyer	Poster Session 3
	5:10 PM	6:15 PM	Peachtree Ballroom	SRME Business Meeting and NAFME 2024 Senior Researcher Address
September 28	7:30 AM	11:00 AM	The Overlook	Registration Open
	7:30 AM	11:00 AM	Peachtree A	Wellness Room open
	8:00 AM	11:25 AM		Presentation Sessions
	11:35 AM	12:50 PM	Peachtree B - Foyer	Poster Session 4

Hotel Floor Plan

Society and editorial committee meetings on September 25 will be held on the 12th floor (Piedmont Level).

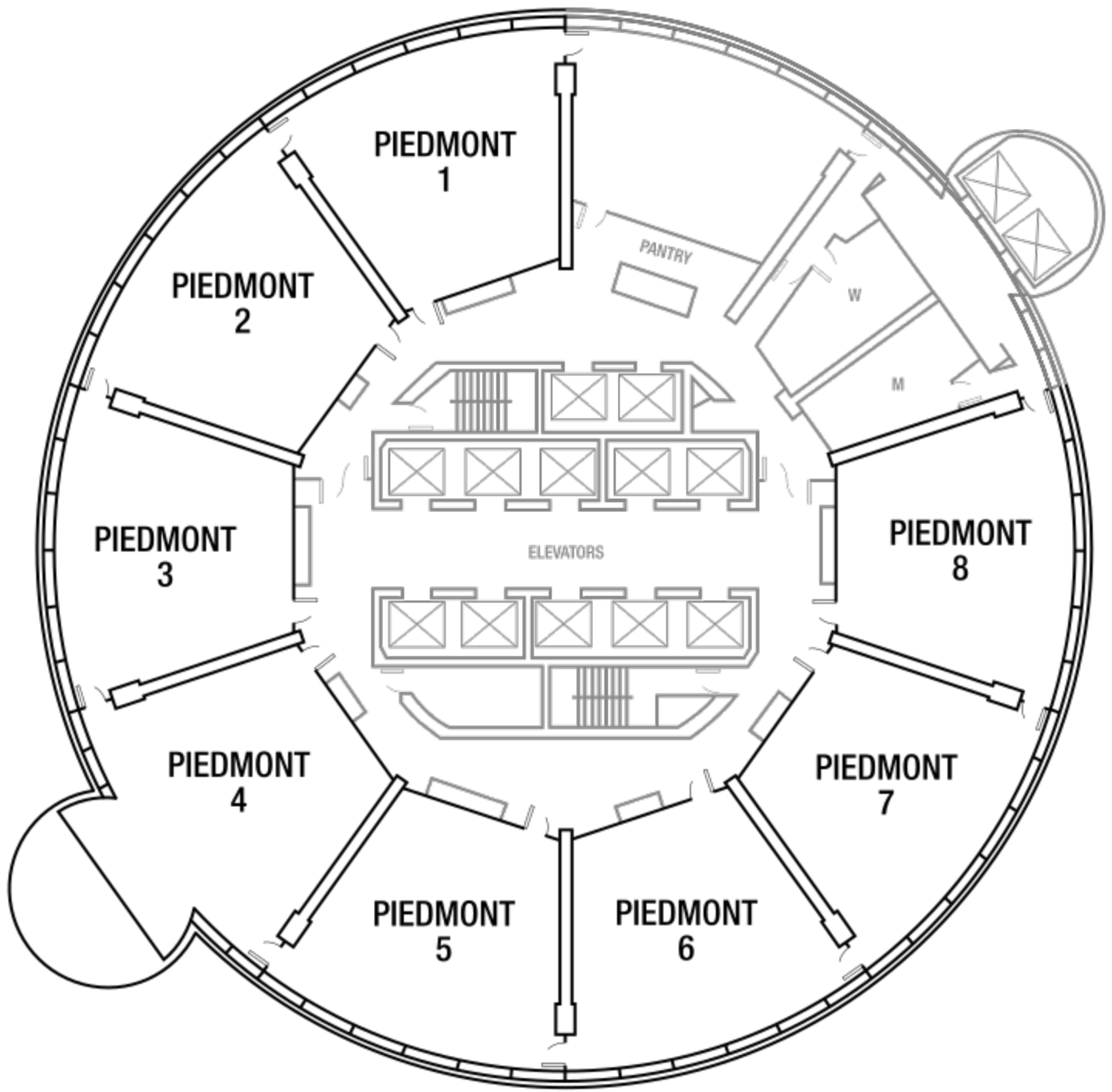

Hotel Floor Plan

Conference presentation sessions will be held September 25-28 on the 6th level (Chastain rooms) and on the 7th level (Augusta rooms).

Conference registration will be located at The Overlook on the 6th level.

AUGUSTA 7TH LEVEL

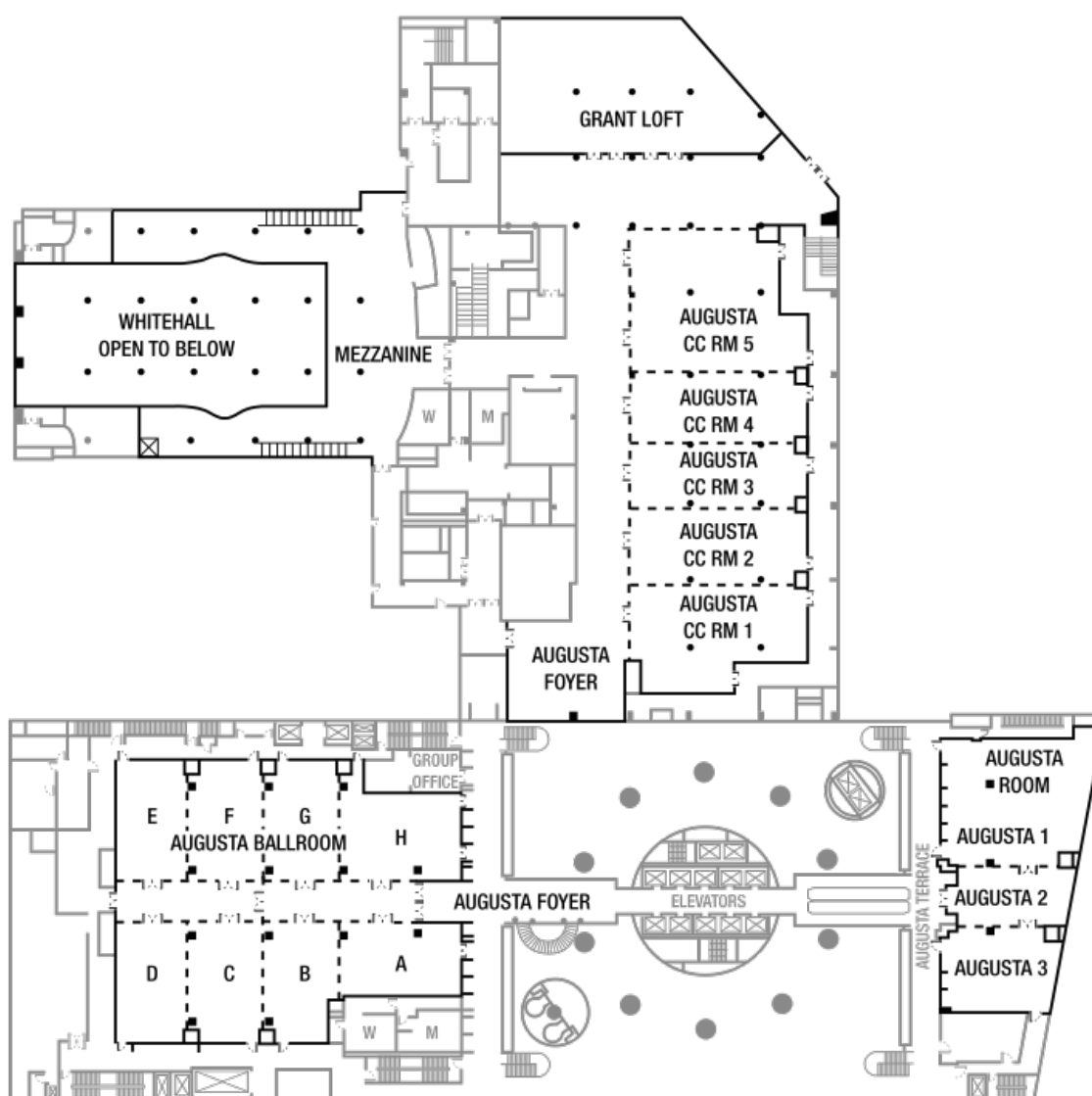

Hotel Floor Plan

Conference presentation sessions will be held September 25-28 on the 6th level (Chastain rooms) and on the 7th level (Augusta rooms).

Conference registration will be located at The Overlook on the 6th level.

CHASTAIN 6TH LEVEL

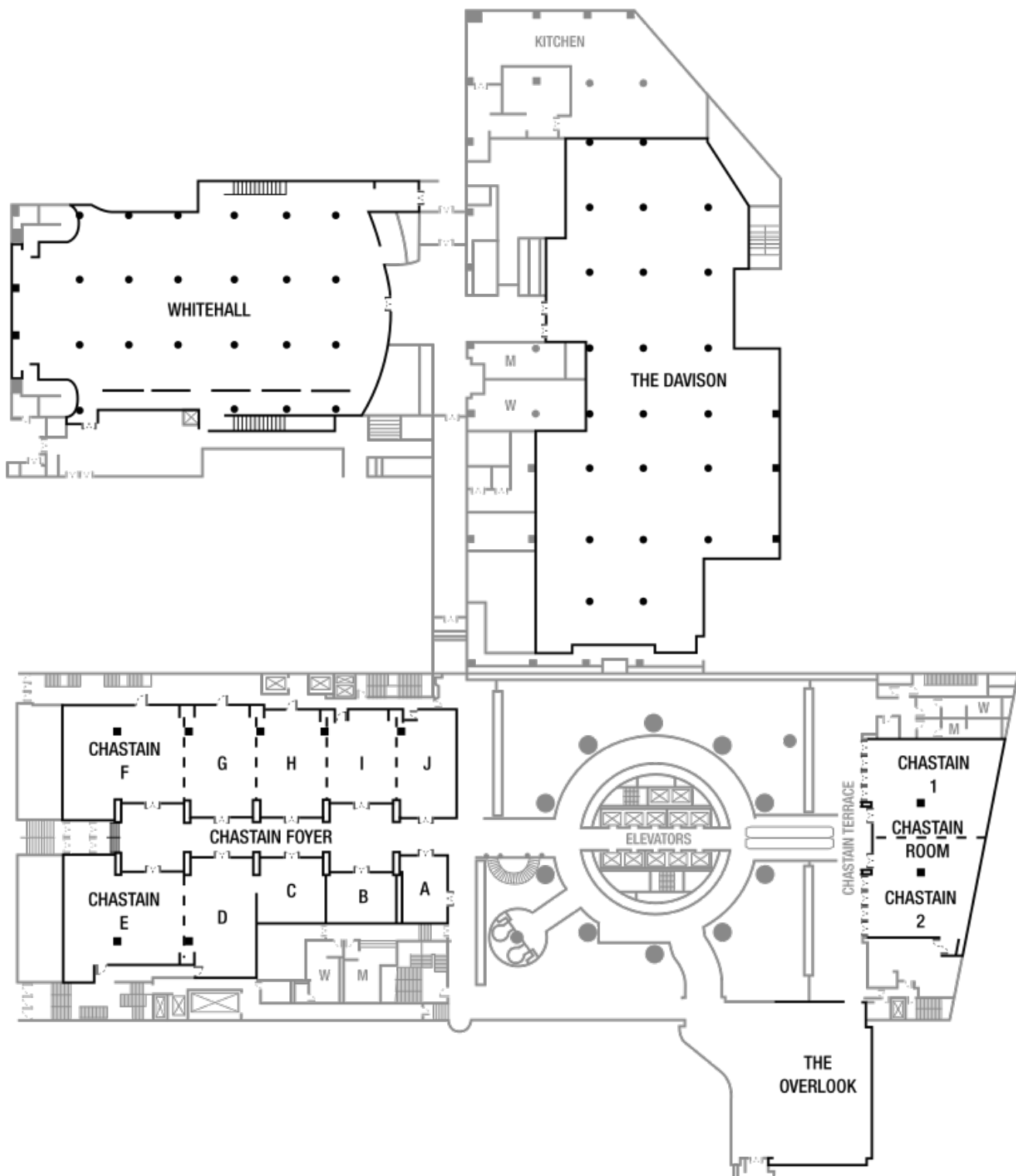

Hotel Floor Plan

The plenary sessions on September 26 and 27 will be held on the 8th floor in the Peachtree Ballroom.

The four poster sessions will take place on the 8th floor, Peachtree level, in Peachtree B, and on the 8th floor Terrace.

PEACHTREE LEVEL, EIGHTH FLOOR

